

P4Pt Forms

Instructions to Configure Browser (Chrome & Firefox)

IMPORTANT TO NOTE

The instructions in this document pertain to those using Chrome or Firefox as their Web browser, to view / download the Adobe PDF fillable P4Pt forms.

Google Chrome see page 2

Mozilla Firefox see page 3

Google Chrome

The later versions of the Google Chrome Web browser (by default) have with their own internal PDF viewer.

This means when opening a PDF file from a website using Chrome, some PDF files such as PDF fillable forms are NOT supported through their internal PDF viewer. As a result you will see the message below to upgrade to the latest version of Adobe Reader, even though you might already have the latest version.

To view the full contents of this document, you need a later version of the PDF viewer. You can upgrade to the latest version of Adobe Reader from www.adobe.com/products/acrobat/readstep2.html
For further support, go to www.adobe.com/support/products/acreader.html

If using the Internet Explorer Web Browser is not an option for you, as a workaround you can configure Chrome by following the simple steps below:

- 1) Open Google Chrome
- 2) In the web address bar (located in the top left area), enter **chrome://plugins** and hit **enter** on your keyboard.

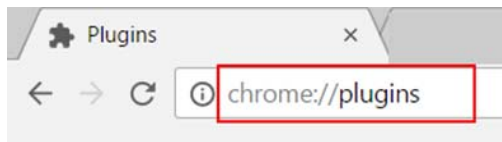

- 3) You will now see the following on your screen:
→ Under Chrome PDF Viewer, click on the **Disable** link

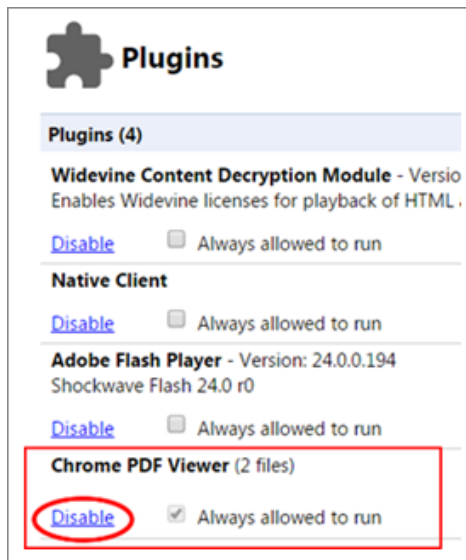

- 4) Close Google Chrome, to allow the changes take effect
- 5) Open Google Chrome, go to the P4Pt website to access the P4Pt PDF forms
- 6) Click on the PDF form that you need to access and within 30 seconds or so, the PDF form will automatically open up in Adobe Reader.



30 seconds +/- to open PDF form

As mentioned above, please be patient as it could take Chrome up to 30 seconds +/- to open the PDF form in Adobe Reader.

Mozilla Firefox

The later versions of the Mozilla Firefox Web browser (by default) have with their own internal PDF viewer.

This means when opening a PDF file from a website using Firefox, some PDF files such as PDF fillable forms are NOT supported through their internal PDF viewer. As a result you will see the message below to upgrade to the latest version of Adobe Reader, even though you might already have the latest version.

To view the full contents of this document, you need a later version of the PDF viewer. You can upgrade to the latest version of Adobe Reader from www.adobe.com/products/acrobat/readstep2.html
For further support, go to www.adobe.com/support/products/acroreader.html

If using the Internet Explorer Web browser is not an option for you, as a workaround you can configure Firefox by following the simple steps below:

- 1) Open Mozilla Firefox
- 2) In the top right corner, click the **menu** button

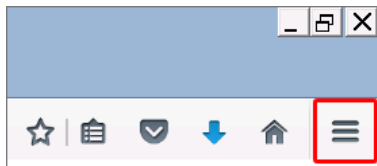

- 3) In the pop-out window, selection **Options**

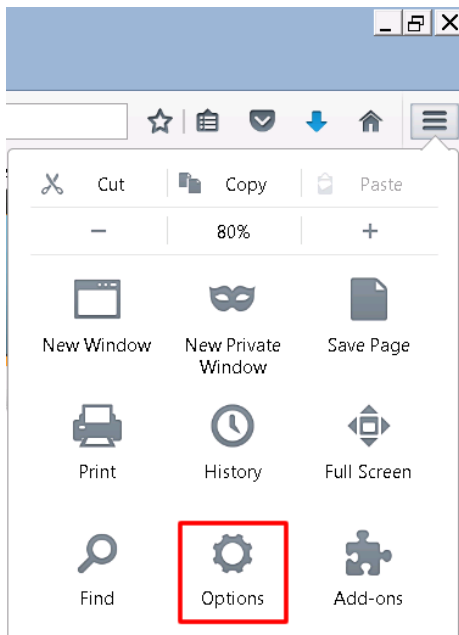

4) In the left navigation, select **Applications**

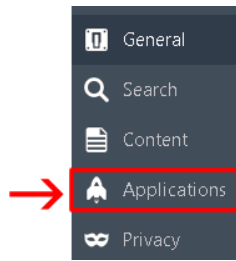

5) Find and click on **Portable Document Format (PDF)**

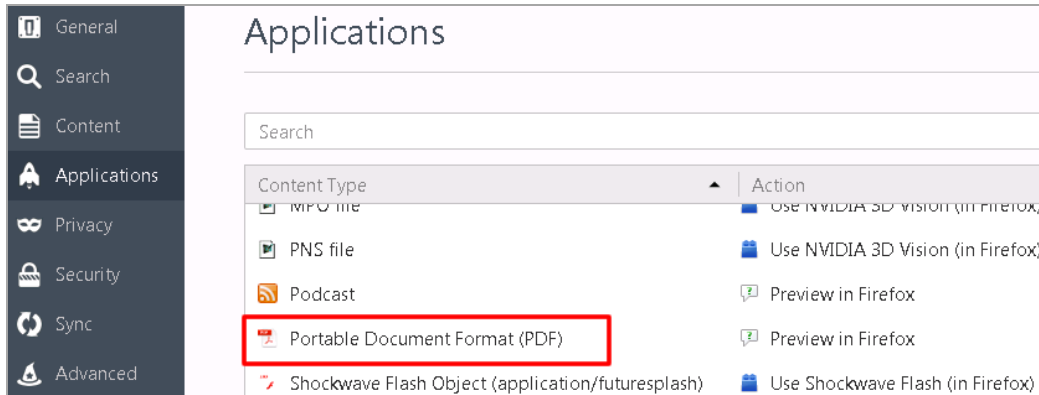

6) A) In the Action column for the content type Portable Document Format (PDF), click on the drop-down arrow for **Preview in Firefox**

B) In the list of choices, select the **Adobe Acrobat Reader** version that you *should* have installed on your computer

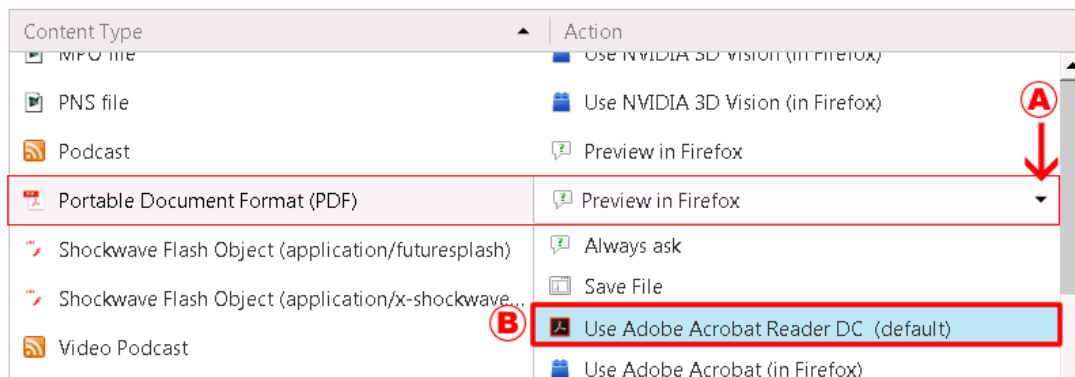

7) Close Mozilla Firefox, to allow the changes take effect

5) Open Mozilla Firefox, go to the P4Pt website to access the P4Pt PDF forms

6) Click on the PDF form that you need to access and within 30 seconds or so, the PDF form will automatically open up in Adobe Reader.



30 seconds +/- to open PDF form

As mentioned above, please be patient as it could take Firefox up to 30 seconds +/- to open the PDF form in Adobe Reader.